

TRACKSO INSTALLATION GUIDE FOR SUNGROW INVERTERS

Brand: Sungrow

Type: Solar On Grid String Inverter

Models: SG 20KTL, SG33KTL-M, SG40KTL-M, SG49K5J, SG50KTL-M, SG60KU, SG60KU-M, SG60KTL, SG60KTL-M, SG36KTL-M, SG8KTL-M, SG10KTL-M, SG12KTL-M, SG80KTL, SG80KTL-M, SG80HV

CONNECTION DIAGRAM

The communication terminals (RS485) are located at the bottom of the inverter. And there are two connection terminals on the configuration circuit board: RS485 A/B terminal blocks and RJ45 plug in terminals

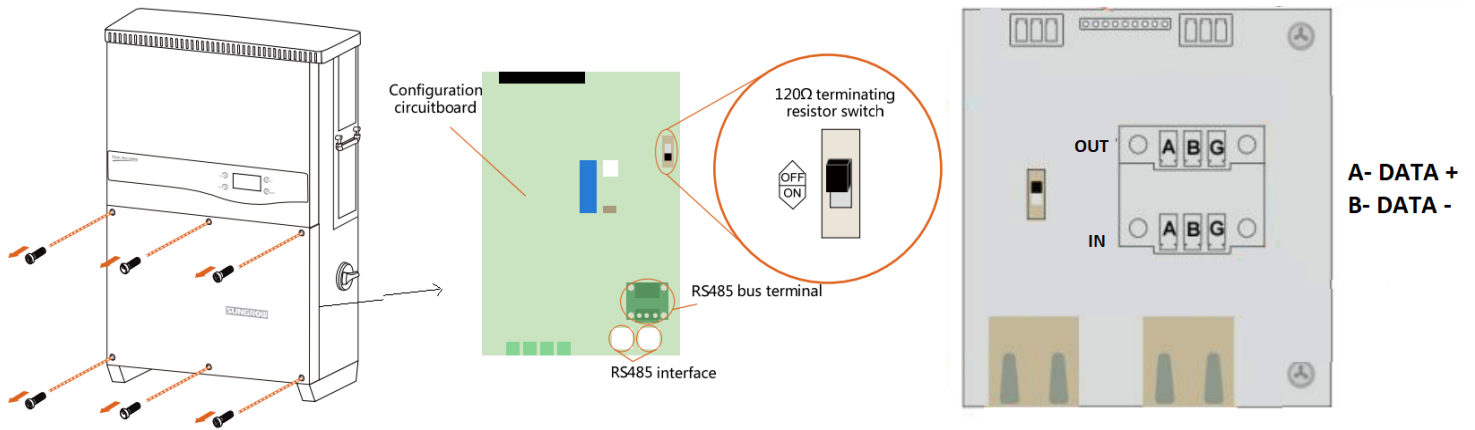
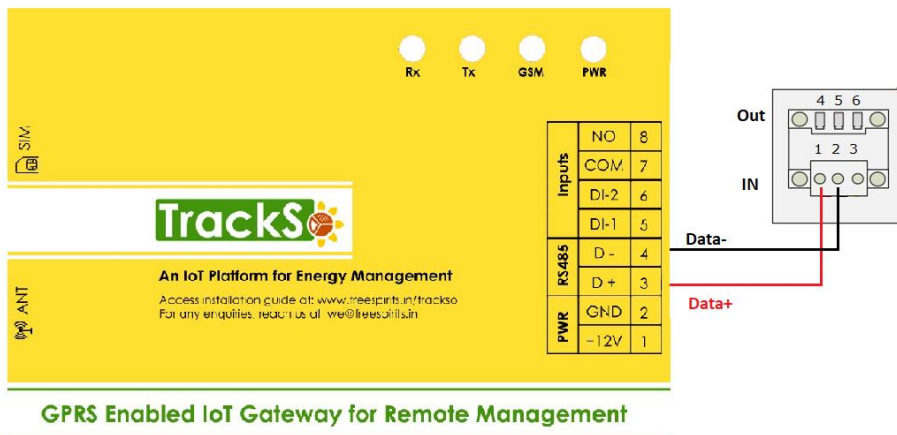

Figure S1 – Sungrow String Inverter Connections

Connection Steps

1. Loose the six screws on the lower connection cabinet
2. The communication terminals (RS485 A/B) are located at the bottom of the inverter as shown in Figure S1.
3. Connect the cables to the RS485 bus terminal blocks.
4. Please make the connections from the Terminal Block chip to TrackSo IoT Gateway as mentioned in the Table – ST1.



Inv Pin No. & Assignment		TrackSo Pin No. & Assignment	
1	A	3	D+
2	B	4	D-
3	GND		
4	A	Used for Daisy Chain	
5	B		
6	GND		

Table ST1 – Sungrow RS485 chip connections with TrackSo IoT Gateway

DEFAULT CONFIGURATION IN TRACKSO IOT GATEWAY

Inverter ID: **1, 2, 3, 4** Continuous numbering starting with 1, (**Range:** 1 to 247)
Baud Rate: **9600 (Default) (Values:** 9600, 19200, 38400)
Data Bits: 8 , Stop Bit: 1 , Parity: None

CONFIGURATION AT THE INVERTER END

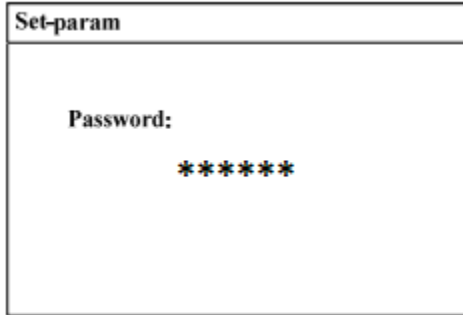

The admin password for entering the Install Settings is 091030.

SETTING THE BAUD RATE

If you connect multiple inverters via RS485, set the same baud rate on each inverter.

← Set the Inverter baud rate to 9600

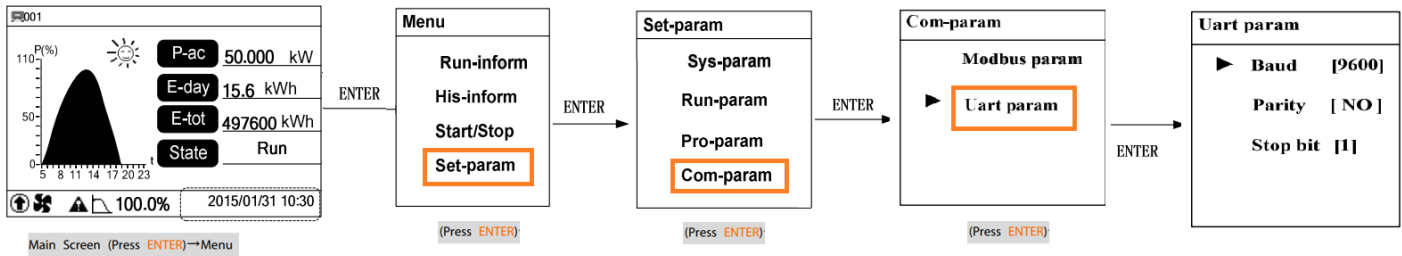

SETTING THE INVERTER ID

The inverter ID is used to identify the inverter in a RS485 connection

- Set a different inverter ID for each inverter in the PV plant. Otherwise, the inverters cannot be correctly identified.
- On the last inverter in the RS485 connection, switch on the RS485 termination resistor.

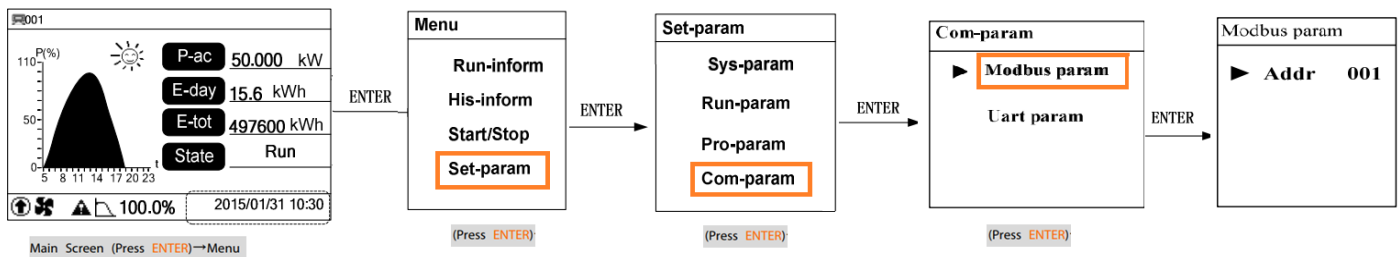

← Set correct Inverter Ids

SET DATE & TIME OF INVERTER

For a precise calculation of the statistics in the inverter itself and in a monitoring system, date and time have to be correct.

← Set the Correct Date & Time

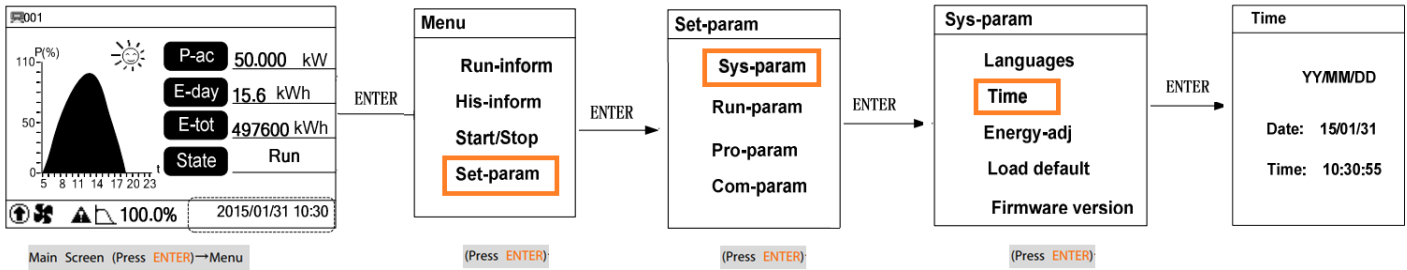

Communication Card Settings

Single Inverter

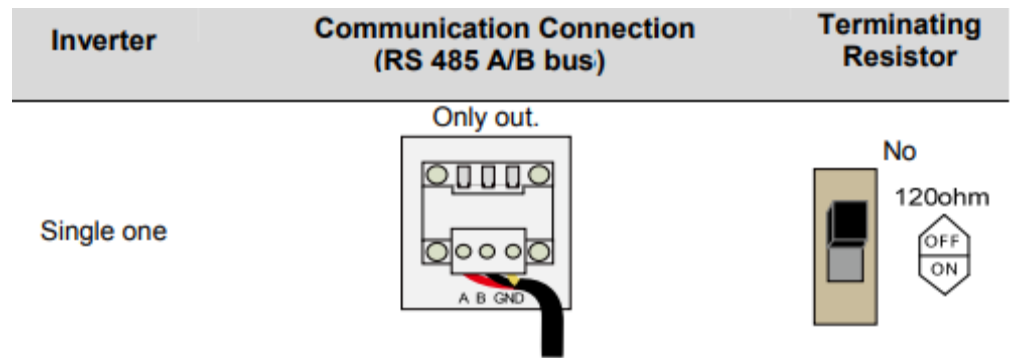

Multiple Inverters

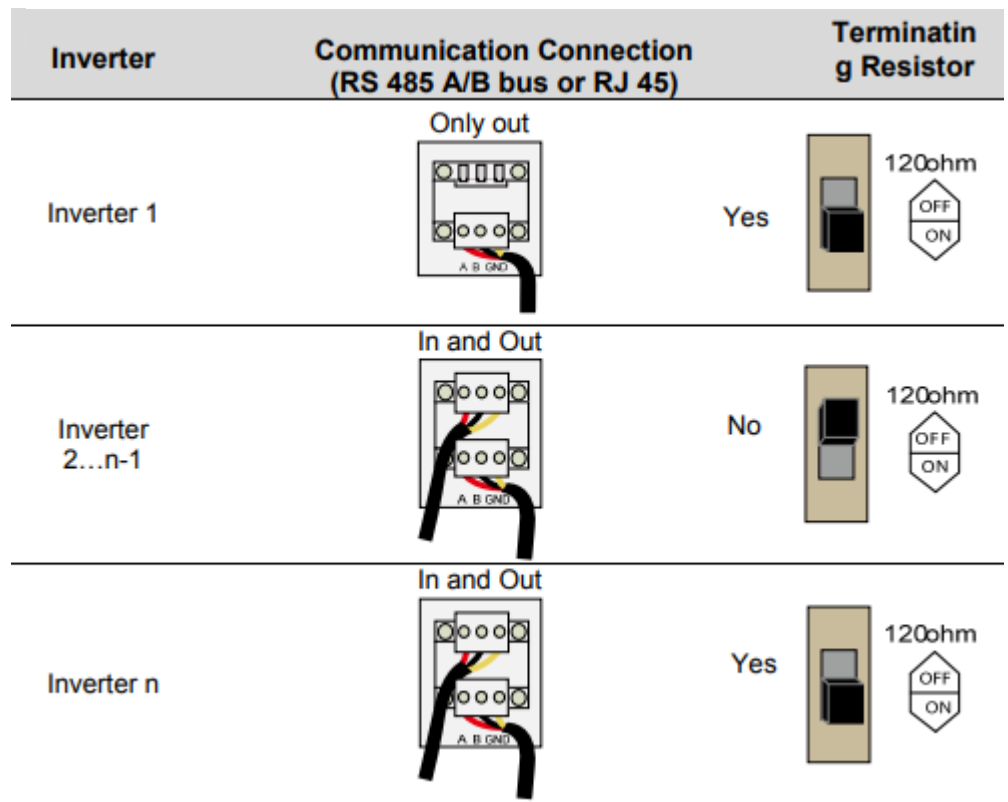

NOTE: The above details are mentioned in the [Installation & Operation Manual](#) for Sungrow Inverter-SG60KU on **Page 99**.